

Cylinder Accessories ▶ Cylinder mountings; series CM1

Bearing block, Series AB7

▶ Cylinder mounting in accordance with ISO 15552



00105160

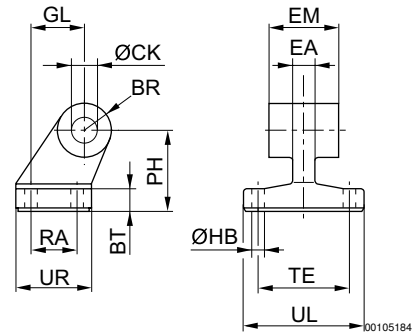

00105184

Part No.	Piston Ø	BR	BT	Ø CK H9	Ø HB H13	EM	GL JS14	EA 1)	PH JS15	RA JS14	TE JS14
1825805275	32	10	8	10	6.6	26 -0,2/-0,6	21	10	32	18	38
1825805276	40	11	10	12	6.6	28 -0,2/-0,6	24	12	36	22	41
1825805277	50	13	12	12	9	32 -0,2/-0,6	33	16	45	30	50
1825805278	63	15	12	16	9	40 -0,2/-0,6	37	16	50	35	52
1825805279	80	15	14	16	11	50 -0,2/-0,6	47	20	63	40	66
1825805280	100	19	15	20	11	60 -0,2/-0,6	55	20	71	50	76
1825805281	125	22,5	20	25	14	70 -0,5/-1,5	70	30	90	60	94
1825805282	160	31.5	25	30	14	90 -0,5/-1,5	97	36	115	88	118
1825805283	200	31.5	30	30	18	90 -0,5/-1,5	105	40	135	90	122
1825805284	250	40	35	40	22	110 -0,5/-1,5	128	45	165	110	150

Part No.	UL 1)	UR 1)									
1825805275	51	31									
1825805276	54	35									
1825805277	65	45									
1825805278	67	50									
1825805279	86	60									
1825805280	96	70									
1825805281	124	90									
1825805282	156	126									
1825805283	162	130									
1825805284	200	160									

1) Max.
Material: Nodular graphite iron
Surface: galvanized