

Nut for cylinder mounting, Series MR3

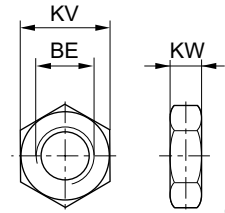

00106400



00126600

Part No.	Piston Ø	For series	BE	KV	KW	Weight [kg]	Note				
1823300024	8, 10	MNI	M12x1,25	17	5.5	0.008	1) 4)				
2915A51204	12, 16	MNI	M16x1,5	22	6	0.01	1) 4)				
2915051207	20, 25	CSL-RD MNI	M22x1,5	30	7	0.02	1) 4)				
0413215803	8, 10	ICM	M12x1,25	17	6.75	0.05	2)				
0413214505	16	ICM	M16x1,5	24	7	0.004	2)				
0413214602	20, 25	ICM	M22 x1,5	30	8	0.004	2)				
0413214718	32	ICM	M30x1,5	41	11	0.01	2)				
3008010180	80	102	M24x2	36	8	0.04	1) 4)				
3056010180	60, 85	102	M24	36	8	0.04	1) 4)				
3012010180	113, 160	102	M36x3	52	10	0.13	1) 4)				
3075010180	250	102	M48x3	65	12	0.18	1) 4)				
R913030290	20, 25	CSL-RD	M22 x1,5	32	11	0.05	3)				

- 1) Material: Steel
- 2) Material: Polyamide, fiber-glass reinforced
- 3) Material: Stainless steel
- 4) Surface: galvanized