

Flexible plate coupling, Series PM7

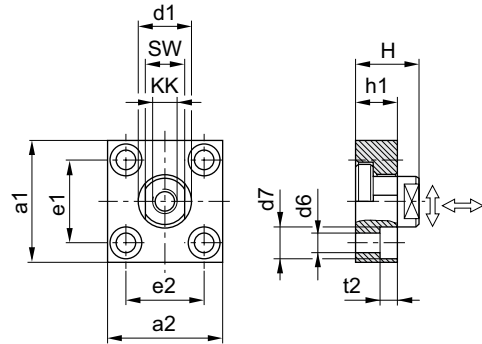

00105170



00105194

Part No.	KK	a1	a2	d1 h11	d6 H13	d7 H13	e1 H13	e2	h1	t2	H
1827001629	M10x1,25	60	37	20	6.6	11	36 ±0,15	23 ±0,15	15	7	24
1827001630	M12x1,25	60	56	25	9	15	42 ±0,2	38 ±0,2	20	9	30
1827001631	M16x1,5	80	80	30	11	18	58 ±0,2	58 ±0,2	20	11	32
1827001632	M20x1,5	90	90	40	14	20	65 ±0,3	65 ±0,3	20	13	35
1827001633	M27x2	90	90	40	14	20	65 ±0,3	65 ±0,3	20	13	35
1827001634	M36x2	125	125	60	18	26	90 ±0,3	90 ±0,3	30	17	55

Part No.	SW	Tightening torque for the coupling pin Ma ± 5%	Axial play	Radial play	Material	Surface	Weight		
		[Nm]	[min./max.]	[min./max.]			[kg]		
1827001629	17	17	0.4 - 0.8	1.9 - 2.3	Steel	galvanized	0.3		
1827001630	19	29	0.4 - 0.8	1.9 - 2.3	Steel	galvanized	0.4		
1827001631	24	71	0.4 - 0.8	1.9 - 2.3	Steel	galvanized	0.9		
1827001632	36	138	0.4 - 0.8	1.9 - 2.3	Steel	galvanized	1.15		
1827001633	36	350	0.4 - 0.8	1.9 - 2.3	Steel	galvanized	1.1		
1827001634	50	1080	0.4 - 0.95	2.8 - 3.4	Steel	galvanized	3.4		